

The logo features the name "McFARLANE" in a large, bold, sans-serif font. Below it, "MFG. CO. INC." is written in a smaller font. To the right of the company name, "Sauk City, Wisconsin" is printed. The entire logo is set against a dark circular background.**McFARLANE**MFG. CO.  
INC.

Sauk City, Wisconsin

MANUFACTURERS OF QUALITY AGRICULTURAL EQUIPMENT SINCE 1936

OPERATOR'S MANUAL  
AND  
PARTS LISTING  
FOR THE

**7055**

Non-Folding 3 Point Lift  
with Chain Harrow

VERSION: 10-04AJF

TO THE OWNER AND OPERATORS

Before assembling or operating this unit, READ THIS MANUAL THOROUGHLY. To obtain the best performance of the unit, familiarize yourself with each component and adjustment. Store this manual where it can be readily available for future reference. In the event that the harrow or any part of the unit should be sold, be sure that the new owner receives a copy of this manual for their reference.

1330 DALLAS STREET, P.O. BOX 100  
SAUK CITY, WISCONSIN 53583  
PHONE: (608) 643-3321  
TOLL FREE: (800) 627-8569 FAX: (608) 643-3976

## INTRODUCTION

Thank you for purchasing your new McFarlane 3-pt lift and harrow sections. We know that you will get many years of dependable service from this modernly designed unit.

You may have had a particular application in mind when you purchased this unit. There are actually many uses for the McFarlane harrow including incorporation of herbicides and pesticides, leveling and smoothing tilled soil, and covering of broadcast seeds. Contact your dealer if you would like more information or have questions concerning these or other applications.

## LIMITED WARRANTY

### FULL ONE - YEAR WARRANTY OF

7055  
Non-Folding 3-pt Lift

If within one year from the date of purchase, this 3-pt lift and/or its accompanying harrow sections fail due to defect in material or workmanship, McFarlane Mfg. Co., Inc. will repair it, free of charge.

Warranty service is available by simply contacting the nearest McFarlane dealership throughout the United States or Canada.

This warranty applies only while this product is used in the United States or Canada.

This warranty gives you specific legal rights, and you may have other rights which vary from state to state.

McFarlane Mfg. Co., Inc., Sauk City, Wisconsin 53583

### CONTACT INFORMATION

If you have questions not answered in this manual, require additional copies, or the manual is damaged, please contact your local dealer or:

McFarlane Mfg. Co., Inc.  
1330 Dallas Street  
P.O. Box 100  
Sauk City, WI 53583

PHONE: (608) 643-3321  
TOLL FREE: (800) 627-8569  
FAX: (608) 643-3976

### BOLT TORQUE SPECIFICATIONS

Coarse Thread Series		
Nut Size and Threads per Inch	Nut Tightening Torque (lb.ft.)	
Grade C Nuts		
	Max.	Min.
1/4 - 20	14.7	10
5/16 - 18	22.3	15.2
3/8 - 16	39	28
7/16 - 14	60	44
1/2 - 13	88	63
9/16 - 12	134	98
5/8 - 11	172	127
3/4 - 10	295	218
7/8 - 9	440	317
1 - 8	651	506

Fine Thread Series		
Nut Size and Threads per Inch	Nut Tightening Torque (lb.ft.)	
Grade C Nuts		
	Max.	Min.
1/4 - 28	14.7	10
5/16 - 24	23.4	18.4
3/8 - 24	41	30
7/16 - 20	60	44
1/2 - 20	98	70
9/16 - 18	134	98
5/8 - 18	176	127
3/4 - 16	295	218
7/8 - 14	440	317
1 - 14	703	610

## STEP - BY - STEP ASSEMBLY INSTRUCTIONS

### Attach the Lift Arms

Note: Setup of this unit is easiest if the tool bar is first attached to a tractor.

1. Attach the lift arms and pull points to the tool bar using the 7/16" x 1 1/2" bolts, lock washers and hex nuts. Space the lift tubes 40" apart, center on the tool bar. Refer to figure 1.

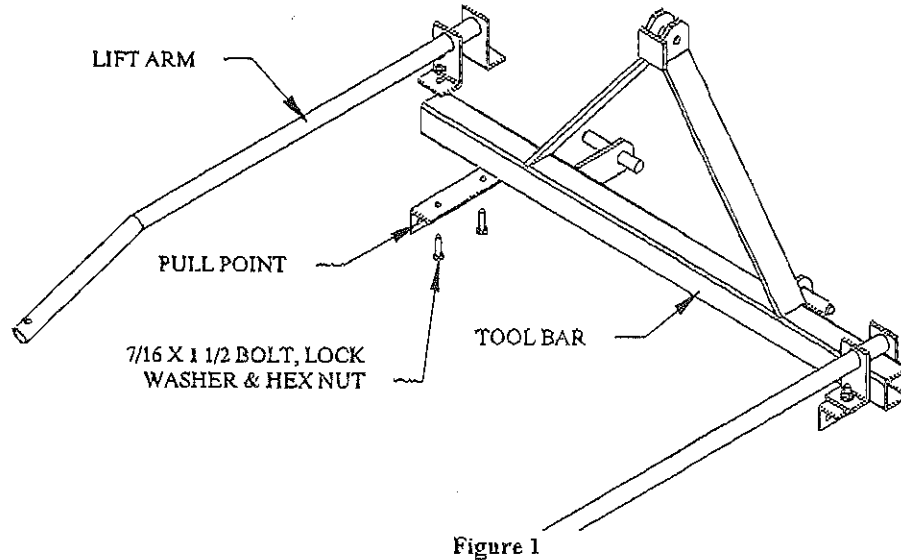

### Attach the Pull Tube & Section

1. Bolt the 6-link pull chains to the pull points. Use 7/16 x 1 1/2 bolts, lock washers and hex nuts. Refer to figure 2.
2. Bolt the pull chains to the pull tube. Use 1/2 x 1 1/2 bolts, flat washers, lock washers and hex nuts. Refer to figure 2.
3. Attach the section pull hooks to the pull tube. Refer to figure 2.

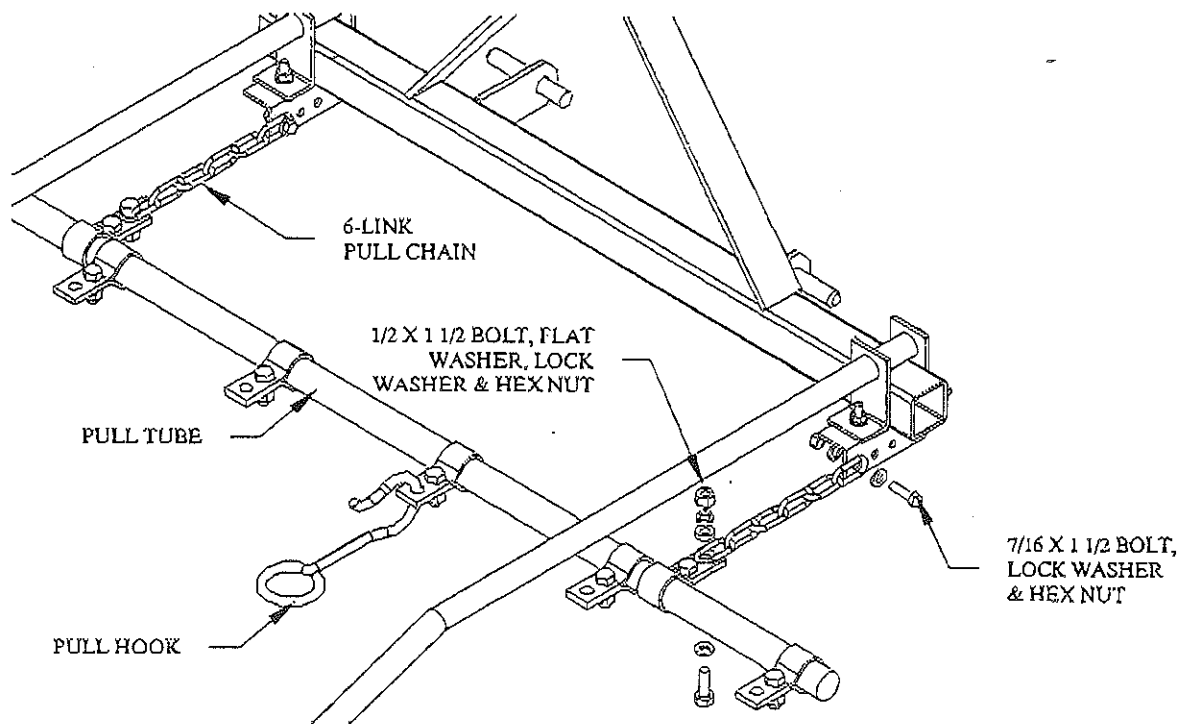

Figure 2

### Attach the Lift Chains & Stabilizer Angle

1. Pull the unit forward a few feet to take the slack out of the harrow section and pull chains.
2. Directly below the stabilizer angle, wrap a 16 Link Lift Chain around a harrow section cross piece and feed the chain back through the large 1 1/2" ring on the end of the chain.
3. Bolt the stabilizer angle and the free end of the lift chain to the rear of the lift tube. Referring to figure 3, use 7/16 x 2 bolts and lock nuts.

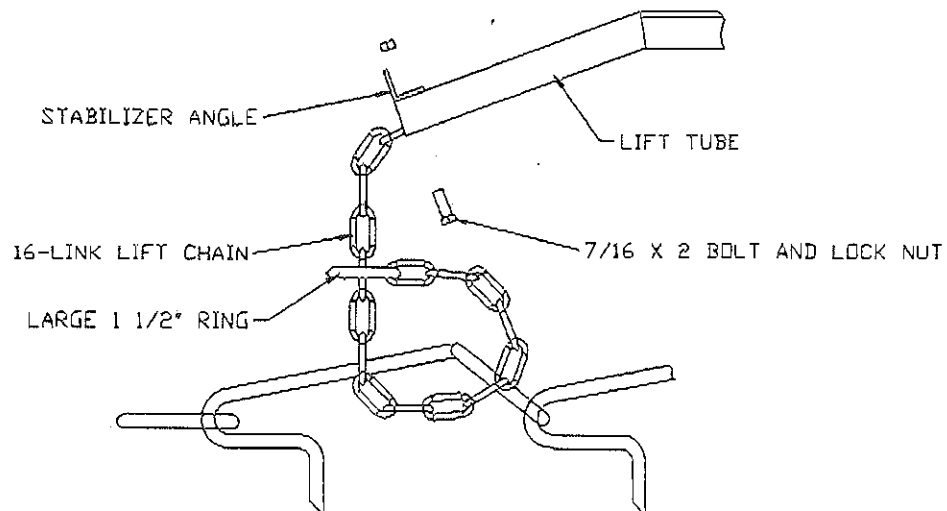

Figure 3

### Final Adjustments

1. Lower the unit into the field position.
2. Pull the completed unit ahead a few feet to check that everything is properly assembled and that nothing is binding or misaligned.
3. Check to make sure that all bolts and fasteners are tight.
4. With the unit in the transport position, attach the red and amber reflectors at the widest visible points. The red reflectors should be visible from the rear of the unit, and the amber reflectors should be visible from the front of the unit.
5. After the first few hours of operation, check all fasteners and tighten if necessary.

This completes the assembly of your harrow and 3-pt lift. Before using the unit, double check that all components have been assembled properly. If there are any questions regarding any of the assembly steps, contact your local dealer for an explanation. Do not operate this or any equipment unless you are sure that all components operate as they were designed to operate.

### 7055 3-PT LIFT PARTS DIAGRAM

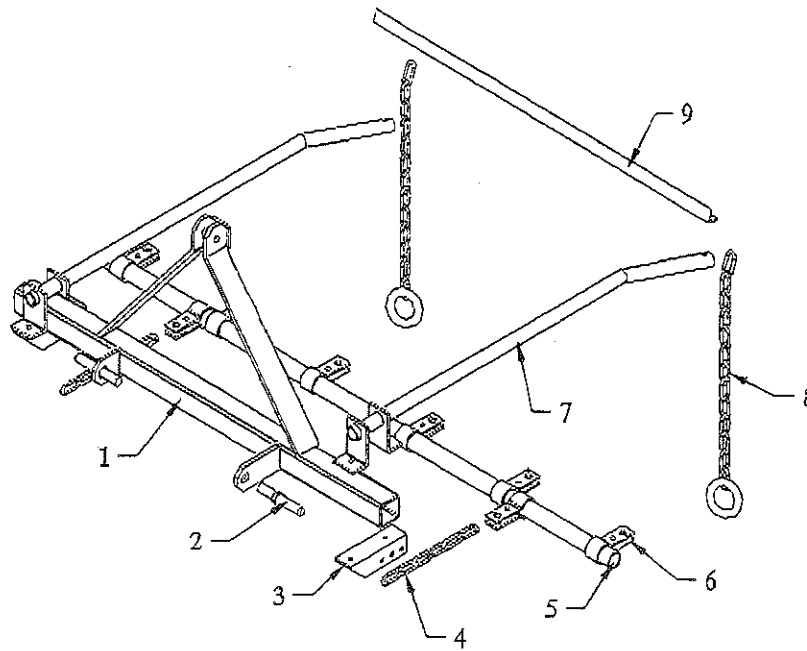

KEY	PART #	DESCRIPTION	QTY.
1	N-706	7055 TOOL BAR	1
2	N-014	CAT I HITCH STUD	2
3	N-008	PULL POINT	2
4	CH-0706	6-LINK PULL CHAIN	2
5	PT-1059	PULL TUBE	1
6	HD-1197	PULL TUBE CLEVIS	8
7	N-020	LIFT ARM	2
8	CH-1516	16-LINK LIFT CHAIN	2
9	N-009	STABILIZER ANGLE	1

Bolts, washers, nuts, and cotter pins are not shown. Refer to the setup instructions for details.

McFarlane Manufacturing reserves the right to change specifications of design at any time without obligation to modify previous products.